

Firm Profile

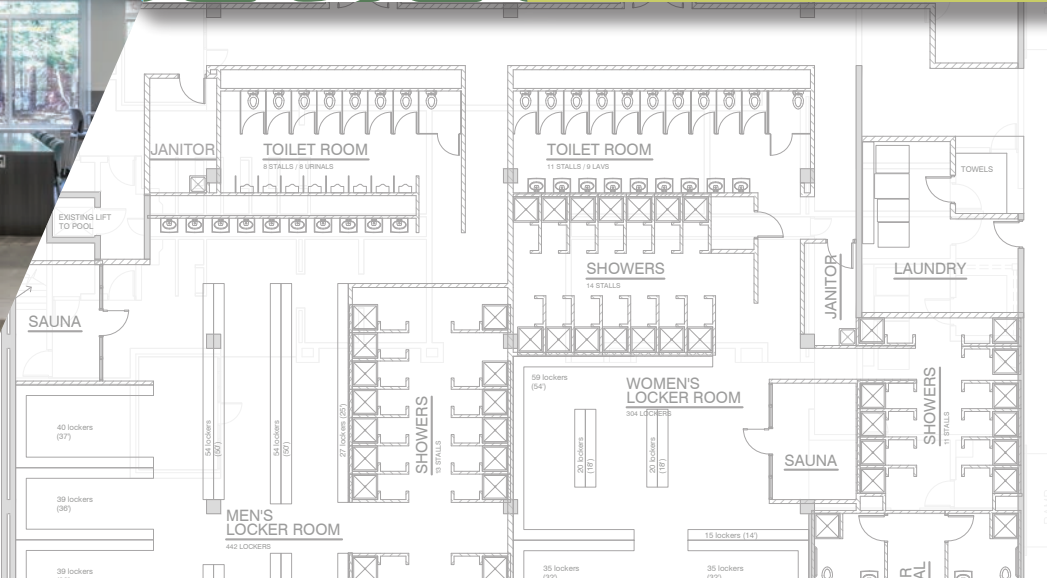

ADA

Architectural Design Associates
3410 O Street, Suite A
Lincoln, NE 68520
402.486.3232 | www.adalincn.com



The ADA logo consists of the letters 'ADA' in a bold, white, serif font, set against a dark green rectangular background. The logo is positioned on the left side of the page, overlapping a light green and blue background.

Architectural Design Associates, P.C.

3410 O Street, Suite A

Lincoln, NE 68510

402.486.3232 | www.adalincoln.com

About Us

Architectural Design Associates (ADA) of Lincoln, NE, is the lead firm of the Design Team. ADA is a full-service architectural design firm established in 1989 as a Professional Corporation (P.C.). ADA has provided professional, client-focused architectural design services to diverse projects throughout the Midwest for over 30 years. We offer an extensive experience in a wide range of new construction, renovation and remodeling projects including Recreation/Sports Complexes, Educational Facilities, Industrial Complexes, Health Care Centers, Retail Establishments, Correctional Facilities, Institutional Facilities, Corporate/Office Buildings, Financial Institutions, Multi-Family Housing and Religious Buildings.

ADA's Principals and Project Managers David Wiebe and John Hathaway have carefully assembled a team of nine hard-working professionals, including five architects, one project manager, one architectural technician, one intern architect and an office manager. Their combined experience and personal attention make what could be an overwhelming design process enjoyable and rewarding. ADA is currently licensed to practice in the states of Nebraska, Kansas, Colorado, Iowa, Missouri, Oklahoma and South Dakota.

Our attention to detail and quality relationships keeps our clients coming back. We take great pride in the fact that many of our projects come from repeat clients:

- Lincoln Parks and Recreation Department
- Lincoln Public Schools
- University of Nebraska-Lincoln and Kearney
- Lincoln Police Department
- Union College
- Lincoln Water System
- Lincoln Fire and Rescue
- Peru State College

Their trust in us speaks to the quality of our work and focus on client service of our people.



At Architectural Design Associates our motto is simple: “It’s Your Project.” Our talented and attentive team asks lots of questions – and we listen to your answers. Your dreams, needs and goals guide our ideas and solutions from the initial concepts to the ribbon cutting. We get to know you and establish a comfortable working relationship – fostering mutual respect and open and honest communication. While our professionals bring a wealth of architectural experience to the table, we don’t bring preconceived ideas about what’s right for you.

Each member of our team will bring a set of unique and exceptional skills to your project. Our professionals understand the intricacies and specific characteristics that each type of facility demands. As with all of our projects, ADA will approach yours with an innovative eye, integration of technology, preservation of existing elements when desired, and attention to sustainability.

Once your project begins, we keep the conversation flowing with frequent communication— discussing evolving needs and offering design alternatives. And throughout the design and construction process, we make your job easier by serving as your representative to contractors, city and state code officials, and other consultants.

Using programs such as Autodesk® Revit® and Google SketchUp Pro® allows us to create 3-D digital models. These models let us illustrate and develop our ideas at a higher quality and depth. The models also let our clients explore and experience the project via perspective images, video walk-throughs, and virtual reality walk-throughs, allowing

them to make further input during the design and help avoid changes during construction.

Architectural Design Associates believes that quality is in the details. That’s why our building designs include sharp, aesthetically pleasing plans that are also practical and cost-effective to build. This attention to detail is reflected in the drawings themselves, which are meticulously created with a high level of precision and accuracy.

Contractors appreciate our detailed drawings because they allow jobs to flow smoothly – with fewer on-site challenges and changes. Clients, too, appreciate our expertise – knowing that quality drawings result in projects that are completed on time and on budget.

Our tradition of dedication, professionalism and outstanding client service is a testament to that mission as we strive each day for excellence in bringing our valued clients’ ideas to life in the constructed environment.

Our Firm



John Hathaway | AIA | Principal | Project Manager

John has served as the project manager and project architect on many successful projects with complex programs and challenging budgetary constraints. His ability to incorporate technically challenging building elements into existing and new structure displays an eye for detail that serves him well in project management. John utilizes strong communication and organization skills to maintain a pulse on the project from preliminary design through final completion.

RELEVANT PROJECTS

- Peru State College - Theatre/ Community Event Center Program Statement, Renovation and Addition, Peru, Nebraska
- Wilderness Ridge Country Club – New Golf Training Center and Pro Shop, Lincoln, Nebraska
- Lincoln Parks and Recreation\ Nebraska Game and Parks, Boosalis Park Indoor Shooting Range, Lincoln, Nebraska
- Lincoln Public Schools, Scott Middle School Gymnasium and Classroom Addition, Lincoln, Nebraska
- Lincoln Public Schools, Lux Middle School Gymnasium Addition, Lincoln, Nebraska
- Ravenna Public Schools, Performance Space, Ravenna, Nebraska
- Beatrice Public Schools, Paddock Lane Remodel, Beatrice, Nebraska
- State of Nebraska, Hastings Regional Center, Facility upgrades, Hastings, Nebraska
- Lincoln Police Department, Fleet Maintenance Relocation and Addition, Lincoln, Nebraska
- Huvepharma, Inc., Animal Science laboratory projects, Lincoln, Nebraska

PROFESSIONAL PRACTICE

2016-Present Principal, Architectural Design Associates, Lincoln, NE
2011-2016 Project Architect, Architectural Design Associates, Lincoln, NE
2007-2011 Intern Architect, BVH Architects, Lincoln, NE

YEARS OF EXPERIENCE

14 Years | 10 Years with ADA

EDUCATION

Bachelor of Science in Architectural Studies, University of Nebraska, 2007
Masters of Architecture, University of Nebraska, 2009

PROFESSIONAL AFFILIATIONS

American Institute of Architects (AIA)
Current President:
AIA Lincoln

REGISTRATIONS

Licensed Architect:
•Nebraska
•South Dakota
•Iowa



David Wiebe | LEED® AP | AIA | Principal | Project Manager

David will be the Design Architect for the project. He has over 30 years of architectural experience in the Lincoln area with Bachelor's and Master's degrees from the University of Nebraska – Lincoln. Governmental experience includes work with City, State and Federal agencies for new office, medical, fire station, recreational and educational buildings. Private experience also includes the design and project management of office and medical buildings; residential and nursing facilities; retail stores and buildings; industrial buildings; and religious facilities.

PROFESSIONAL AFFILIATIONS

- American Institute of Architecture (AIA)
- Leadership in Energy and Environmental Design (LEED-AP)
- National Council of Architectural Registration Boards (NCARB)

REGISTRATIONS

- Registered Professional Architect:
- Nebraska
 - Kansas
 - Oklahoma

RELEVANT PROJECTS

- LPS - Holmes Elementary School – IAQ and Media Center remodel, Lincoln, Nebraska
- LPS - Eastridge Elementary School – IAQ and Library remodel, Lincoln, Nebraska
- LPS - Seacrest Press Box, Copple Center, Lincoln, Nebraska
- LPS - Mickle Middle School – IAQ, classroom and Library additions, Lincoln, Nebraska
- Adams Community Center – remodel, Adams, Nebraska
- Village of Eagle Community Center – new building construction drawings, Eagle, Nebraska
- Lincoln Parks & Recreation – Pinewood Bowl Performer's Building, Lincoln, Nebraska
- Lincoln Parks & Recreation – Wilderness Day Camp Building, Lincoln, Nebraska
- Lincoln Fire & Rescue - Station 1 kitchen and common area remodel, Lincoln, Nebraska
- Adams Fire Station and Training Center, Adams, Nebraska
- Sun Valley Lanes – Mini golf, laser tag, volleyball and lounge additions, Lincoln, Nebraska
- UNL Campus Recreation Center study – Lincoln, Nebraska
- UNL Love Library auditorium remodel – Lincoln, Nebraska
- Sesostris Shrine Center – new building remodel, Lincoln, Nebraska
- Scottish Rite Masonic Center – Reception Hall remodel, Lincoln, Nebraska
- Old Cheney Rehabilitation – Rehabilitation and care center, Lincoln, Nebraska
- Viewpoint Office Building – new medical office building, Lincoln, Nebraska
- Veterans Affairs Regional Office Building – new building, Lincoln, Nebraska
- Lincoln Park & Rec/Nebraska Game & Parks – Nebraska Outdoor Education Center, Lincoln, Nebraska
- Family of Christ Church – new building construction drawings, Kearney, Nebraska
- Union College Student Center – remodel – Lincoln, Nebraska
- Nebraska Bank – new building, Hickman, Nebraska
- York General Hospital – new dialysis building, York, Nebraska

PROFESSIONAL PRACTICE

2002-Present	Architectural Design Associates
1997-2002	Wiebe & Johnson
1996-1997	Architecture & Design
1987-1990, 1992-1996	Thiessen & Associates Architects

YEARS OF EXPERIENCE

34 Years | 19 Years with ADA

EDUCATION

Bachelor of Science in Architectural Studies, University of Nebraska, 1987
Mater of Architecture, University of Nebraska, 1992

Our Firm

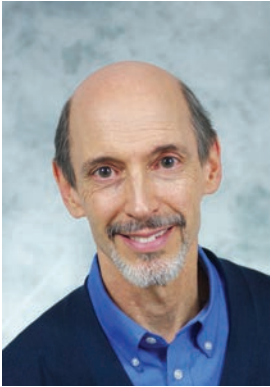

REGISTRATIONS

Registered
Professional
Architect:
•Nebraska

David Stirtz | Project Architect

David has more than 29 years of experience as a licensed Architect. As a Project Architect, David is responsible for project design and development and the preparation of detailed documents, code research, construction cost estimates, coordination of the design team and client meeting, production of construction documents, and assisting with bidding, negotiation, construction administration, and contract preparation. David's work is meticulous and highly accurate. His excellent communication skills build strong client relationships.

RELEVANT PROJECTS

- LPS – Scott and Lux Middle Schools Gym Additions
- LPS – Nutrition Food Stores Projects
- Seacrest Activities Complex
- Humann Elementary – Temporary School Renovation
- LPS - Goodrich Middle School – IAQ, Codes, Additions, & Renovations
- Eastridge Elementary – IAQ & Media Addition
- Brownell Elementary – Addition & IAQ-Codes Upgrade
- Seacrest Field – Sound & Lighting Replacement
- Seacrest Field – Concession & Restroom Remodel
- Neogen-Geneseek – Lab & Office Renovation
- York Hospital Dialysis Project
- The Meadows – Assisted Living Addition
- Lincoln Lutheran Multipurpose Building
- Dialysis Center of Lincoln – Northwest Unit
- Lincoln Police Department – Canine Facility
- Lincoln Police Department – Fleet Maintenance Facility
- Care Initiatives – Pinnacle Specialty Care
- Lincoln Housing Authority – Mahoney Manor

PROFESSIONAL PRACTICE

2000-Present	Architectural Design Associates, Lincoln, NE
1989-2000	The Architectural Partnership, Lincoln, NE
1987-1989	Clark Enersen Partners, Lincoln, NE
1985-1986	Leo A. Daly, Omaha, NE

YEARS OF EXPERIENCE

36 Years | 21 Years with ADA

EDUCATION

Bachelor of Science in Architectural Studies, University of Nebraska, 1985



Chris Pischel | AIA | Project Architect

Chris has 15 years of architectural experience working on a wide variety of projects, from remodels and renovations to new construction. Involved in all phases of the project, Chris is responsible for assisting with the development of preliminary design drawings, completing and assembling final construction documents and performing construction administration. He also works closely with design consultants and the owner. In addition to being proficient in the use of AutoCAD, Revit and Photoshop, Chris's excellent organizational ability has him in charge of managing the company archives of past projects as well as the company's digital content library.



Chris Northup | Project Manager

Chris joined ADA in July 2006, and has over 22 years of experience in architectural design and construction practices on a variety of projects. A few Addition and Renovation projects that he has been involved with over the years are Lincoln Orthopedic Center Addition and Renovation; Horizon Bank Addition and Renovation in Waverly, NE; Union College Physician Assistant Studies Renovation, TJ Majors IAQ Renovations at Peru State College and Goodrich Middle School in Lincoln, NE. Currently Chris is overseeing the Lincoln Surgical Hospital - ASC remodel and the Advanced Medical Imaging remodel and addition.

Chris is exceptionally versatile having spent parts of his career as an owner of a general contracting company, which gives him a unique perspective and understanding for our clients. Along with superior technical skills in preliminary design, construction drawings, writing specifications, estimating and managing projects through all phases of design and construction. Chris also has many years of experience as a consultant for commercial food service design.



Our Firm



Gregory Schepler | Intern Architect

Gregory has shown the ability to ably apply a strong sense of design and thorough research to help in the implementation of all areas of projects. His work at ADA includes: Lincoln Surgical Hospital - ASC Remodel, The Meadows Memory Care facility, Dental Designs, and various residential and commercial projects.

Gregory is passionate about design, how it can shape people's perceptions, and the unique opportunities of every project. He enjoys working with the client and design team to create the best possible project. Design is most successful with critical thinking and creativity, while keeping context and future generations in mind. Using the newest tools and a fresh design approach he has proven to be a crucial member to our project team.

Gregory graduated from the University of Nebraska - Lincoln with his Masters of Architecture in 2015 and is actively working on his professional AXP (Architectural Experience Program) with the final goal of becoming a Licensed Architect.



Geoffrey Childs | Project Architect

Geoffrey brings more than 25 years of experience and design acumen to the ADA team, with projects that span from his work with Walsh Bishop in Minneapolis, Minnesota to arCurectecture in Lincoln, Nebraska as well as time spent as an independent architect. His work has spanned major developments with companies like Marriott and Hilton while balancing simultaneous multi-project involvement. Through his career, he has gained experience as a consultant, project manager, team supervisor and member of design teams, all for expanding his skill and knowledge in the architectural field while designing progressive and quality oriented designs.

Geoffrey prides himself on his skill with both computer and hand drawn design tools to better serve his clients and realize a designs potential.





Dillon McLain | Architectural Technician

Dillon joined ADA in 2015 during an internship for completion of his Architectural Technology program. He has remained with us ever since. Dillon bring a strong level of technical proficiency to his work, as he helps our team leaders flesh out designs into final designs and built projects.



Jada Northup | Business Office Manager

Armed with an impressive business background, Jada is responsible for many duties at ADA – administrator, bookkeeper, account coordinator, administrative assistant, marketing manager and receptionist. She’s skilled in various computer programs, including Microsoft Office (Word, Excel, Publisher and PowerPoint) and Quickbooks Premier. Jada is also a General Notary in the State of Nebraska.



Continuing Care Projects



ADA

Tabitha Green House

4720 Randolph St, Lincoln, Nebraska

Tabitha Health Care Services requested ADA design a series of additional assisted living houses that match the style of their existing Green House together with the surrounding neighborhood.

Each added house functions as a stand-alone program; featuring 12 bedrooms with personal bathrooms, a Library and private rooms, a full kitchen and dining room, in-house staff offices, and meeting rooms.



Pinnacle Specialty Care

1223 Prairie View Road, Cedar Falls, Iowa



Care Initiatives requested a design for a new 100-Unit facility. The new facility featured a state of the art therapy center, beauty shop, large and small dining areas, and full service kitchen.

The facility is arranged in a wagon wheel with primary services and the dining areas at the center while residence rooms, amenities and the therapy centers are located along the wings.



Continuing Care & Retirement Community Experience

Retirement Communities

- Eaglecrest Retirement Community, Salina, KS
- Savannah Pines Retirement Community, Lincoln, NE
- The Oaks Retirement Community, Wayne, NE
- Willow Ridge Retirement Community, McCook, NE
- Independent Living Communities
- Country Clover Estates, O'Neill, NE
- James Tinsley Villas, Omaha, NE
- Riverside Lodge, Grand Island, NE
- Minden West Estates, Minden, NE
- Somers Pointe, Fremont, NE
- Rosewood Estates, Alliance, NE
- Terrace Heights Apartments, Auburn, NE
- Wilderness Falls Senior Housing, Falls City, NE
- West Park Townhomes, North Platte, NE
- Woodland Park Townhomes, Grand Island, NE
- Yorktowne Estates, York, NE
- The Village at Heartland Park, Seward, NE
- Humboldt Senior Community, Humboldt, KS
- Marysville Senior Housing, Marysville, KS
- Stonebrook Villas, Konawa, OK
- Whispering Meadows, Wewoka, OK
- Parkland Townhomes, Prague, OK

Assisted Living Facilities

- Avoca Assisted Living Addition, Avoca, IA
- Haven Manor Assisted Living, Multiple Facilities, Lincoln, NE
- Heartland Park Assisted Living Renovation, Seward, NE
- Regency Care Center 30-Unit Assisted Living Addition, Norwalk, IA
- Regency Square Assisted Living Addition and Remodel, South Sioux City, NE
- The Waterford Assisted Living, Lincoln, NE
- Victory Hills Assisted Living Renovation, Kansas City, KS

Skilled Nursing & Rehabilitation Facilities

- Atlantic Nursing and Rehabilitation Center, Atlantic, IA
- Christian Homes Additions and Renovations, Holdrege, NE
- Creston Nursing and Rehabilitation Center Occupational Therapy Addition, Creston, IA
- Crystal Heights Nursing Care Interior Renovation, Oskaloosa, IA
- Dubuque Nursing and Rehabilitation Center Interior Renovation, Dubuque, IA
- Homestead Rehabilitation Center Renovation, Lincoln, NE
- Lancaster Manor Addition and Renovation, Lincoln, NE
- Mid-Dakota Medical Center Skilled Nursing Unit Addition, Chamberlain, SD
- Northcrest Specialty Care, Waterloo, IA
- Norwalk Elderly Housing, Norwalk, IA
- Parkridge Specialty Care, Pleasant Hill, IA
- Parkview Nursing and Rehabilitation Center, Waterloo, IA
- Pleasant Park Estates Addition and Renovation, Oskaloosa, IA
- Ravenwood Addition, Waterloo, IA
- Silvercrest Miracle Hills Dining Room Remodel & Facility Evaluation, Omaha, NE
- Southern Hills Specialty Care, Osceola, IA
- Sunrise Country Manor Addition/Renovation, Milford, NE
- West Ridge Nursing and Rehabilitation Center, Knoxville, IA
- West View Medical Building Remodel, York, NE

Memory Care & Hospice Facilities

- Southern Hills Specialty Care, Osceola, IA
- The Waterford at Wilderness Hills, Lincoln, NE



Liberty Estates, Waverly, NE

Continuing Care & Retirement Community Experience

Retirement Communities

- Eaglecrest Retirement Community, Salina, KS
- Savannah Pines Retirement Community, Lincoln, NE
- The Oaks Retirement Community, Wayne, NE
- Willow Ridge Retirement Community, McCook, NE
- Independent Living Communities
- Country Clover Estates, O'Neill, NE
- James Tinsley Villas, Omaha, NE
- Riverside Lodge, Grand Island, NE
- Minden West Estates, Minden, NE
- Somers Pointe, Fremont, NE
- Rosewood Estates, Alliance, NE
- Terrace Heights Apartments, Auburn, NE
- Wilderness Falls Senior Housing, Falls City, NE
- West Park Townhomes, North Platte, NE
- Woodland Park Townhomes, Grand Island, NE
- Yorktowne Estates, York, NE
- The Village at Heartland Park, Seward, NE
- Humboldt Senior Community, Humboldt, KS
- Marysville Senior Housing, Marysville, KS
- Stonebrook Villas, Konawa, OK
- Whispering Meadows, Wewoka, OK
- Parkland Townhomes, Prague, OK

Assisted Living Facilities

- Avoca Assisted Living Addition, Avoca, IA
- Haven Manor Assisted Living, Multiple Facilities, Lincoln, NE
- Heartland Park Assisted Living Renovation, Seward, NE
- Regency Care Center 30-Unit Assisted Living Addition, Norwalk, IA
- Regency Square Assisted Living Addition and Remodel, South Sioux City, NE
- The Waterford Assisted Living, Lincoln, NE
- Victory Hills Assisted Living Renovation, Kansas City, KS

Skilled Nursing & Rehabilitation Facilities

- Atlantic Nursing and Rehabilitation Center, Atlantic, IA
- Christian Homes Additions and Renovations, Holdrege, NE
- Creston Nursing and Rehabilitation Center Occupational Therapy Addition, Creston, IA
- Crystal Heights Nursing Care Interior Renovation, Oskaloosa, IA
- Dubuque Nursing and Rehabilitation Center Interior Renovation, Dubuque, IA
- Homestead Rehabilitation Center Renovation, Lincoln, NE
- Lancaster Manor Addition and Renovation, Lincoln, NE
- Mid-Dakota Medical Center Skilled Nursing Unit Addition, Chamberlain, SD
- Northcrest Specialty Care, Waterloo, IA
- Norwalk Elderly Housing, Norwalk, IA
- Parkridge Specialty Care, Pleasant Hill, IA
- Parkview Nursing and Rehabilitation Center, Waterloo, IA
- Pleasant Park Estates Addition and Renovation, Oskaloosa, IA
- Ravenwood Addition, Waterloo, IA
- Silvercrest Miracle Hills Dining Room Remodel & Facility Evaluation, Omaha, NE
- Southern Hills Specialty Care, Osceola, IA
- Sunrise Country Manor Addition/Renovation, Milford, NE
- West Ridge Nursing and Rehabilitation Center, Knoxville, IA
- West View Medical Building Remodel, York, NE

Memory Care & Hospice Facilities

- Southern Hills Specialty Care, Osceola, IA
- The Waterford at Wilderness Hills, Lincoln, NE



Liberty Estates, Waverly, NE

Education Projects



ADA

Union College's Rees Hall

4810 Bancroft Ave, Lincoln, Nebraska

ADA's remodel of Rees Hall brought the building up to modern standards. The new space went through a complete reworking of the lighting system and new furnishings throughout the building to create a better study environment.

All the finishes in the building were updated while still maintaining key features such as the 60's style fireplace. The reception area was also updated to better serve the administration functions of the building.



Peru State College - Performing Arts Center

Peru, Nebraska



Peru State College requested a comprehensive renovation for their still original 1920 performing arts building. This entailed stripping the theater down to the shell and installing up-to-date sound, lighting and projection systems. The theater space was refurbished with new seating and acoustical panels. The existing entry hall and support spaces were demolished to provide larger facilities and a more spacious lobby.

On the exterior, the adjacent green space was developed into an event space and donor plaza. The project also incorporated Peru State's geothermal heating system with several additional wells installed under the event space for this project.



Relevant Education Experience

Lincoln Public Schools, Lincoln, NE

- Seacrest Field – Multiple Projects
- Brownell Elementary – Multiple Projects
- Bryan Community Child Center IAQ Upgrades
- Clinton Elementary – Multiple Projects
- Dawes Middle School IAQ Upgrades
- Eastridge Elementary School Renovation
- Goodrich Middle School – Multiple Projects
- Mickle Middle School Renovation
- Millard-Lefler Media Center Remodel
- Morley Elementary Elevator Addition
- Saratoga Elementary IAQ Upgrades
- West Lincoln Elementary – Multiple Projects
- Southeast High School Elevator Addition

Lincoln Christian School

- Multiple Projects

University of Nebraska-Lincoln, Lincoln, Neb.

- Agriculture Hall Renovation
- Agriculture Research & Development Center Maintenance Building & Interior Finish
- Animal Science – Multiple Projects
- Architectural West Classrooms Remodel
- Ashfall Excavation Site Building and Master Plan
- Avery Hall Renovation
- College of Dentistry Remodel
- East Union Student Center Renovations
- Ferguson Hall Lecture Room Remodel
- Fleming Fields Activity Building Renovation
- Food Industry Building Remodel
- Henzlik Hall Remodel
- Keim Hall Computer Lab Remodel
- Kieselback Laboratory Renovation
- Laser-Assisted Nano-Engineering Laboratory Renovation
- Lied Center Exterior Renovations
- Mabel Lee Hall Remodel
- Midwest Roadside Safety Facility Remodel
- Military and Naval Science Building Remodel
- Natural Resources Building Renovation

Union College, Lincoln, Neb.

- Physician Assistant & International Rescue & Relief Program Area Renovation
- Love Student Center Renovation
- Simulation Lab for Nursing Program
- Bell Tower Lighting
- Prescott Hall Basement Remodel
- Pool Chemical Storage Building
- Advent Source New Facility
- Student Center Remodel
- Entrance Canopy
- Cafeteria/Bakery Relocation

Doane College, Crete, NE

- Nuclear Magnetic Resonance Spectrometer Room Addition

Nebraska Wesleyan University, Lincoln, NE

- Abel Stadium Press Box

Other School Projects

- Elmwood Murdock Elementary Kitchen Renovation
- Hartley Elementary ADA Updates
- Hartley Elementary Elevator Addition
- Mearle Beattie Elementary Media Center Addition
- Saratoga Elementary Elevator Addition
- Peru State College TJ Majors Building, Peru, NE
- Mount Ayr High School Safe Room Addition, Mount Ayr, IA
- West Central High School and Elementary School Safe Room Additions, Stuart, IA
- Church of Holy Spirit Elementary School - New Facility, Plattsmouth, NE
- College of Hair Design, Lincoln, NE
- Nebraska Evangelical Lutheran School – New Facility, Waco, NE
- Indian Hills Community Church Education Wing Addition
- Trinity Lutheran School – New Facility
- Freeman Public Schools Feasibility Study, Adams, NE



Mickle Middle School Addition & Renovation, Lincoln, NE

Relevant Education Experience

Lincoln Public Schools, Lincoln, NE

- Seacrest Field – Multiple Projects
- Brownell Elementary – Multiple Projects
- Bryan Community Child Center IAQ Upgrades
- Clinton Elementary – Multiple Projects
- Dawes Middle School IAQ Upgrades
- Eastridge Elementary School Renovation
- Goodrich Middle School – Multiple Projects
- Mickle Middle School Renovation
- Millard-Lefler Media Center Remodel
- Morley Elementary Elevator Addition
- Saratoga Elementary IAQ Upgrades
- West Lincoln Elementary – Multiple Projects
- Southeast High School Elevator Addition

Lincoln Christian School

- Multiple Projects

University of Nebraska-Lincoln, Lincoln, Neb.

- Agriculture Hall Renovation
- Agriculture Research & Development Center Maintenance Building & Interior Finish
- Animal Science – Multiple Projects
- Architectural West Classrooms Remodel
- Ashfall Excavation Site Building and Master Plan
- Avery Hall Renovation
- College of Dentistry Remodel
- East Union Student Center Renovations
- Ferguson Hall Lecture Room Remodel
- Fleming Fields Activity Building Renovation
- Food Industry Building Remodel
- Henzlik Hall Remodel
- Keim Hall Computer Lab Remodel
- Kieselback Laboratory Renovation
- Laser-Assisted Nano-Engineering Laboratory Renovation
- Lied Center Exterior Renovations
- Mabel Lee Hall Remodel
- Midwest Roadside Safety Facility Remodel
- Military and Naval Science Building Remodel
- Natural Resources Building Renovation

Union College, Lincoln, Neb.

- Physician Assistant & International Rescue & Relief Program Area Renovation
- Love Student Center Renovation
- Simulation Lab for Nursing Program
- Bell Tower Lighting
- Prescott Hall Basement Remodel
- Pool Chemical Storage Building
- Advent Source New Facility
- Student Center Remodel
- Entrance Canopy
- Cafeteria/Bakery Relocation

Doane College, Crete, NE

- Nuclear Magnetic Resonance Spectrometer Room Addition

Nebraska Wesleyan University, Lincoln, NE

- Abel Stadium Press Box

Other School Projects

- Elmwood Murdock Elementary Kitchen Renovation
- Hartley Elementary ADA Updates
- Hartley Elementary Elevator Addition
- Mearle Beattie Elementary Media Center Addition
- Saratoga Elementary Elevator Addition
- Peru State College TJ Majors Building, Peru, NE
- Mount Ayr High School Safe Room Addition, Mount Ayr, IA
- West Central High School and Elementary School Safe Room Additions, Stuart, IA
- Church of Holy Spirit Elementary School - New Facility, Plattsmouth, NE
- College of Hair Design, Lincoln, NE
- Nebraska Evangelical Lutheran School – New Facility, Waco, NE
- Indian Hills Community Church Education Wing Addition
- Trinity Lutheran School – New Facility
- Freeman Public Schools Feasibility Study, Adams, NE



Mickle Middle School Addition & Renovation, Lincoln, NE

Financial Projects



ADA

Midwest Bank

2655 Jamie Ln, Lincoln, Nebraska



Midwest Bank approached ADA to design a bank that projects its own identity while still being recognizable as a Midwest branch location.

This was achieved through the use of different combination of stone, brick, tile and brushed aluminium finishes both inside and out, as well as altering the shape of the building with an additional floor.



Financial Experience

- Midwest Bank, New Branch, Lincoln, NE
- Cornhusker Bank, New Branch, Lincoln, NE
- Security First Bank (Formerly Beatrice National Bank & Trust), Lincoln, NE
- Horizon Bank Addition and Renovation, Waverly, NE
- Auburn State Bank Addition, Auburn, NE
- American National Bank, Lincoln, NE
- Heritage Bank New Branch, Broken Bow, NE



Cornhusker Bank, Lincoln NE

Healthcare Projects



ADA

Lincoln Orthopaedic Center

Lincoln, Nebraska

In 2013, Lincoln Orthopaedic Center had outgrown their existing building and called on ADA to assist them with two building additions along with a complete remodel and update of the existing medical practice. The additions consist of an expansion of the post operation recovery areas to the east, and an expansion to the west side of the building including additional operating and procedure rooms, a new MRI scan room, along with doctor and business offices.

The project was challenging in many ways considering the need for the facility to remain in operation throughout the construction and remodel process over an 18 month schedule. The project was completed in 2015 within the not to exceed budget given by the owner.



Foot and Ankle Specialists

Bellevue, Nebraska



Foot & Ankle Specialists employed ADA to design their new home location west of Bellevue, NE. The new building, features three 'doctors' pods' each including a doctor's office, four treatment rooms and a nurse's station.

The facility's design provides a soothing environment for patients using the selected neutral color pallet and natural finishes throughout the space. In addition, ADA worked with the staff to design an efficient work environment, addressing the issue from their previous facility and providing adequate space in their new location.



Healthcare Experience

- Capital Foot Center Medical Office Building, Lincoln, NE
- Dialysis Center of Lincoln – Multiple Projects
- Foot & Ankle Specialists Medical Office Building, Bellevue, NE
- The Journey House at Tabitha, Lincoln, NE
- CHI Health Kearney Annex, Kearney, NE
- Advanced Medical Imaging Remodel, Lincoln, NE
- Advanced Medical Imaging Remodel, Lincoln, NE
- Children's Dental Clinic Lincoln, NE
- Dialysis Center of Lincoln – Multiple Projects
- Dr. Rao Radiology Oncology Clinic, Lincoln, NE
- Elizabeth Park South Interior Renovation, Lincoln, NE
- Elizabeth Park South X-Ray / Lab Renovation, Lincoln, NE
- Envision Open MRI, Lincoln, NE
- Family Health Physicians Medical Office, Lincoln, NE
- Hospice Care and Beverly Health, Lincoln, NE
- Linc Care Expansion, Williamsburg Village, Lincoln, NE
- Lincoln Endoscopy Medical Office, Laboratories and Multiple Expansions, Lincoln, NE
- Lincoln Orthopedic Physical Therapy New Building, Lincoln, NE
- Lincoln Surgical Group Medical Office, Lincoln, NE
- Mid-Dakota Medical Center Skilled Nursing Unit Addition, Chamberlain, SD
- National Strength & Conditioning New Building, Lincoln, NE
- Nebraska Orthopedics/Prosthetics Services New Building, Lincoln, NE
- Nebraska Urban Indian Wellness Center, Lincoln, NE
- North American Biologicals (NABI) Biomedical Center, Lincoln, NE
- Nova Care Laboratory, Lincoln, NE
- Pawnee City Hospital CT Scan & Remodel, Pawnee City, NE
- Pawnee County Memorial Hospital Medical Clinic, Pawnee City, NE
- The Physicians Network – Multiple Projects
- St. Elizabeth Regional Medical Center – Multiple Projects
- Superior Medical Imaging N. 27th Facility, Lincoln, NE
- Veterans Based Community Outpatient Clinic, Excelsior Springs, MO
- York General Hospital: CT Unit Addition, York, NE
- York Hospital Clinic Expansion, York, NE
- York Hospital: Wellness Center, York, NE



Dental Designs, Lincoln NE

Healthcare Experience

- Capital Foot Center Medical Office Building, Lincoln, NE
- Dialysis Center of Lincoln – Multiple Projects
- Foot & Ankle Specialists Medical Office Building, Bellevue, NE
- The Journey House at Tabitha, Lincoln, NE
- CHI Health Kearney Annex, Kearney, NE
- Advanced Medical Imaging Remodel, Lincoln, NE
- Advanced Medical Imaging Remodel, Lincoln, NE
- Children's Dental Clinic Lincoln, NE
- Dialysis Center of Lincoln – Multiple Projects
- Dr. Rao Radiology Oncology Clinic, Lincoln, NE
- Elizabeth Park South Interior Renovation, Lincoln, NE
- Elizabeth Park South X-Ray / Lab Renovation, Lincoln, NE
- Envision Open MRI, Lincoln, NE
- Family Health Physicians Medical Office, Lincoln, NE
- Hospice Care and Beverly Health, Lincoln, NE
- Linc Care Expansion, Williamsburg Village, Lincoln, NE
- Lincoln Endoscopy Medical Office, Laboratories and Multiple Expansions, Lincoln, NE
- Lincoln Orthopedic Physical Therapy New Building, Lincoln, NE
- Lincoln Surgical Group Medical Office, Lincoln, NE
- Mid-Dakota Medical Center Skilled Nursing Unit Addition, Chamberlain, SD
- National Strength & Conditioning New Building, Lincoln, NE
- Nebraska Orthopedics/Prosthetics Services New Building, Lincoln, NE
- Nebraska Urban Indian Wellness Center, Lincoln, NE
- North American Biologicals (NABI) Biomedical Center, Lincoln, NE
- Nova Care Laboratory, Lincoln, NE
- Pawnee City Hospital CT Scan & Remodel, Pawnee City, NE
- Pawnee County Memorial Hospital Medical Clinic, Pawnee City, NE
- The Physicians Network – Multiple Projects
- St. Elizabeth Regional Medical Center – Multiple Projects
- Superior Medical Imaging N. 27th Facility, Lincoln, NE
- Veterans Based Community Outpatient Clinic, Excelsior Springs, MO
- York General Hospital: CT Unit Addition, York, NE
- York Hospital Clinic Expansion, York, NE
- York Hospital: Wellness Center, York, NE



Dental Designs, Lincoln NE

Metal Building Projects



ADA

UNL Ashfall Pavillion

Royal, Nebraska

ADA was approached by The University of Nebraska to design the structure around the Ashfall Excavation Site. The combination of the steep grade around the excavation as well as the need to preserve its contents provided a unique challenge.

The metal shell and walkways cover 17,500 square feet allowing access for the public to experience the continued excavation of the site. As well as giving access to the archaeologists and volunteers that work on the site. The completed shell also allows for further excavative efforts to be conducted year round.



WOOF! Dog Care

1300 Infinity Ct, Lincoln, Nebraska



WOOF! Dog Care contracted ADA for their new full-service veterinarian clinic, canine day care and kennel facility. The 15,000 square foot building supports the variety of program elements, allowing clients and their dogs to enter the large vaulted atrium and have direct access to the offered services.

ADA worked hand in hand with the WOOF! staff to address concerns they had from previous locations. From the front entry area to the kennels at the rear of the building, natural light fills the interior from generous windows and clerestory openings, providing the animals and staff a better environment. The site was also leveraged to allow for a larger building, indoor gym and directly adjacent outdoor play areas helping the staff transition between the areas more seamlessly.



Industrial & Metal Building Experience

- Raymond Rural Fire Station, Raymond, NE
- Boosalis Park Indoor Shooting Range, Lincoln, NE
- Linweld, Lincoln, NE and Red Oak, IA
- Ameritas Hanger Mezzanine, Lincoln, NE
- Athey Painting New Shell Building, Lincoln, NE
- Benchmark Biolabs Metal Building Brainard, NE
- Brester Construction Corporate Office and Warehouse, Lincoln, NE
- Cameron Homes Warehouse, Lincoln, NE
- Capitol City Storage, Lincoln, NE
- East O Storage, Lincoln NE
- FedEx Facility Expansion, Grand Island, NE
- Floors Inc. Warehouse, Omaha, NE
- General Excavating Mini Storage, Lincoln, NE
- General Excavating Warehouse, Lincoln, NE
- Gretna Fire Station, Gretna, NE
- H & H Self Storage 4 New Buildings, Hickman, NE
- HDS Warehouse 1 & 2, Lincoln, NE
- Isco, Lincoln, NE
- Kush Furniture, Omaha, NE
- Lincoln Airport Authority Hangar, Lincoln, NE
- LynncO, Lincoln, NE
- Midlands Packaging, Lincoln, NE
- Omaha Public Power District 6 Bay Garage, Fort Calhoun, NE
- Papillion Sanitation Service, Papillion, NE
- St. Elizabeth's Portable Cath Lab, Lincoln, NE
- Sutherland's, Lincoln, NE
- University of Nebraska-Lincoln Agriculture Research and Development Center New Facility, Mead, NE
- US Properties 168,000 SF Warehouse, Lincoln, NE
- York Adopt-A-Pet, York, NE



Linweld, Lincoln, NE

Industrial & Metal Building Experience

- Raymond Rural Fire Station, Raymond, NE
- Boosalis Park Indoor Shooting Range, Lincoln, NE
- Linweld, Lincoln, NE and Red Oak, IA
- Ameritas Hanger Mezzanine, Lincoln, NE
- Athey Painting New Shell Building, Lincoln, NE
- Benchmark Biolabs Metal Building Brainard, NE
- Brester Construction Corporate Office and Warehouse, Lincoln, NE
- Cameron Homes Warehouse, Lincoln, NE
- Capitol City Storage, Lincoln, NE
- East O Storage, Lincoln NE
- FedEx Facility Expansion, Grand Island, NE
- Floors Inc. Warehouse, Omaha, NE
- General Excavating Mini Storage, Lincoln, NE
- General Excavating Warehouse, Lincoln, NE
- Gretna Fire Station, Gretna, NE
- H & H Self Storage 4 New Buildings, Hickman, NE
- HDS Warehouse 1 & 2, Lincoln, NE
- Isco, Lincoln, NE
- Kush Furniture, Omaha, NE
- Lincoln Airport Authority Hangar, Lincoln, NE
- LynncO, Lincoln, NE
- Midlands Packaging, Lincoln, NE
- Omaha Public Power District 6 Bay Garage, Fort Calhoun, NE
- Papillion Sanitation Service, Papillion, NE
- St. Elizabeth's Portable Cath Lab, Lincoln, NE
- Sutherland's, Lincoln, NE
- University of Nebraska-Lincoln Agriculture Research and Development Center New Facility, Mead, NE
- US Properties 168,000 SF Warehouse, Lincoln, NE
- York Adopt-A-Pet, York, NE



Linweld, Lincoln, NE

Municipal Projects



ADA

Lincoln Police Department Fleet Maintenance Building

100 Oakcreek Dr, Lincoln, Nebraska

The Lincoln Police Department selected ADA through the RFP process to design their new Fleet Maintenance facility. The building was designed as a remodel of an existing structure and an addition, on a site which required substantial work to mitigate flood plain concerns.

The functions include vehicle repair capabilities for all small City of Lincoln vehicles in addition to maintaining the Lincoln Police force vehicles. Additionally, office, waiting, body shop, and welding spaces were accommodated in the program. The facility included the integration of a commercial grade paint booth facility, vehicle exhaust recovery system, and bulk fluid distribution systems. The general building structure is a pre-engineered metal building addition to an existing block warehouse.



Raymond Rural Fire & Rescue

Raymond, Nebraska



ADA designed a much-needed new facility for the hard-working volunteers of the Raymond Rural Fire Department. The 15,800 square-foot structure features paired overhead doors that allow emergency rescue vehicles to drive completely through the facility.

The building includes offices, training room, locker room facilities, kitchen, storage, a file room and a decontamination/laundry room. A portion of the station was designed as a hardened storm shelter to meet FEMA F4 tornado requirements.



Municipal Experience

- Bennet Post Office Exterior Renovation, Bennet, NE
- People's City Mission Homeless Intervention Center Remodel, Lincoln, NE
- Farm Services Administration Addition, Scottsbluff, NE
- Farm Services Administration, Eads, CO
- Lincoln Fire Department Station #1 Roof Replacement, Lincoln, NE
- Lincoln Fire Department Station #7 Site Study, Lincoln, NE
- Lincoln Fire Department Station #8 Garage Addition, Lincoln, NE
- Lincoln Fire Department Station #8 HVAC Upgrade, Lincoln, NE
- Lincoln Parks & Rec Office Building Expansion, Lincoln, NE
- Office of Disability Adjudication & Review, Springfield, MO
- Social Security Administration Office Building, Burlington, IA
- Social Security Administration Office Building, Cape Girardeau, MO
- Social Security Administration Office Building, Jefferson City, MO
- Social Security Administration Office Building, Mason City, IA
- Social Security Administration Office Building, Ottumwa, IA
- US Amateur Confederation/Roller Skating Museum, Lincoln, NE
- USDA Office Remodel, Wilber, NE



People's City Mission Homeless Intervention Center, Lincoln, NE

Municipal Experience

- Bennet Post Office Exterior Renovation, Bennet, NE
- People's City Mission Homeless Intervention Center Remodel, Lincoln, NE
- Farm Services Administration Addition, Scottsbluff, NE
- Farm Services Administration, Eads, CO
- Lincoln Fire Department Station #1 Roof Replacement, Lincoln, NE
- Lincoln Fire Department Station #7 Site Study, Lincoln, NE
- Lincoln Fire Department Station #8 Garage Addition, Lincoln, NE
- Lincoln Fire Department Station #8 HVAC Upgrade, Lincoln, NE
- Lincoln Parks & Rec Office Building Expansion, Lincoln, NE
- Office of Disability Adjudication & Review, Springfield, MO
- Social Security Administration Office Building, Burlington, IA
- Social Security Administration Office Building, Cape Girardeau, MO
- Social Security Administration Office Building, Jefferson City, MO
- Social Security Administration Office Building, Mason City, IA
- Social Security Administration Office Building, Ottumwa, IA
- US Amateur Confederation/Roller Skating Museum, Lincoln, NE
- USDA Office Remodel, Wilber, NE



People's City Mission Homeless Intervention Center, Lincoln, NE

Office Building Projects



ADA

Firespring & Cornerstone Printing

1201 Infinity Ct, Lincoln, Nebraska

Firespring and Cornerstone Printing asked ADA to provide design services to renovate an existing space for a new joined office and warehouse facility.

The finished building provides room for both teams and projected future growth, using a flexible modular furniture system to emphasize core circulation to shared spaces.

The primary complexity of the project while meeting the needs and desires of both parties within a very tight budget. Despite the challenges, the end result is a dynamic, creative work environment that exemplifies ADA's attention to design.



The Viewpoint at Lincolnshire

7001 A St, Lincoln, Nebraska



Hampton Enterprises contracted ADA to design the flagship space for their Lincolnshire development, with special concern for seasonal weather. The ViewPoint office complex is composed of three floors on the areas high point, providing a stunning view to the Northwest, over central Lincoln.

The entry leverages the multi-floor layout to provide a spacious two-story lobby with high levels of southern daylight. The lobby is further enhanced with the added covered drop-off. The building also includes a secure, underground parking garage to serve both tenants and visitors.



Office Building Experience

- Veterans Affairs Regional Office Building, Lincoln, NE
- National Rural Electrical Cooperative Association Corporate Office Building, Lincoln, NE
- The Viewpoint at Lincolnshire, Lincoln, NE
- Pioneer's Pointe Plaza Office Park, Lincoln, NE
- 44 Corporate Place Lots 1 and 2 Office Buildings, Lincoln, NE
- Brester Construction New Corporate Office Building & Warehouse, Lincoln, NE
- Nebraska Association of County Officials, Lincoln, NE
- Bair Investments Corporate Office, Lincoln, NE
- Commercial Investment Properties and Home Real Estate, Lincoln, NE
- Commercial Investment Properties Corporate Office Building, Lincoln, NE
- Concord Enterprises Corporate Office Building, Lincoln, NE
- Corporate Centre Office Park, Multiple Buildings, Lincoln, NE
- Farm Services Administration Addition, Scottsbluff, NE
- Farm Services Administration, Sidney, IA
- General Excavating Corporate Office Building, Lincoln, NE
- GTECH Corporate Office, Lincoln, NE
- Highland Village Multiple Office Buildings, Lincoln, NE
- Hofferber Investment Office Building, Lincoln, NE
- Lincoln Parks & Rec Office Building Expansion, Lincoln, NE
- Midlands Financial Benefits Office Building, Lincoln, NE
- Morning Glory Office Park Shell Office Building, Lincoln, NE
- National Insulation Office Remodel, Lincoln, NE
- Nebraska Rural Energy Association Office Expansion, Lincoln, NE
- Office of Disability Adjudication & Review, Jefferson City, MO
- Office of Disability Adjudication & Review, Springfield, MO
- Schrader and Sons Refuse Services Office Building, Lincoln, NE
- Social Security Administration Office Building, Burlington, IA
- Social Security Administration Office Building, Mason City, IA
- Social Security Administration Office Building, Ottumwa, IA
- Software Technologies Office Building, Lincoln, NE
- Voss Electric Corporate Office and Warehouse, Lincoln, NE
- Williamsburg Village, Multiple Office Buildings, Lincoln, NE



Brester Construction Corporate Office, Lincoln, NE

Office Building Experience

- Veterans Affairs Regional Office Building, Lincoln, NE
- National Rural Electrical Cooperative Association Corporate Office Building, Lincoln, NE
- The Viewpoint at Lincolnshire, Lincoln, NE
- Pioneer's Pointe Plaza Office Park, Lincoln, NE
- 44 Corporate Place Lots 1 and 2 Office Buildings, Lincoln, NE
- Brester Construction New Corporate Office Building & Warehouse, Lincoln, NE
- Nebraska Association of County Officials, Lincoln, NE
- Bair Investments Corporate Office, Lincoln, NE
- Commercial Investment Properties and Home Real Estate, Lincoln, NE
- Commercial Investment Properties Corporate Office Building, Lincoln, NE
- Concord Enterprises Corporate Office Building, Lincoln, NE
- Corporate Centre Office Park, Multiple Buildings, Lincoln, NE
- Farm Services Administration Addition, Scottsbluff, NE
- Farm Services Administration, Sidney, IA
- General Excavating Corporate Office Building, Lincoln, NE
- GTECH Corporate Office, Lincoln, NE
- Highland Village Multiple Office Buildings, Lincoln, NE
- Hofferber Investment Office Building, Lincoln, NE
- Lincoln Parks & Rec Office Building Expansion, Lincoln, NE
- Midlands Financial Benefits Office Building, Lincoln, NE
- Morning Glory Office Park Shell Office Building, Lincoln, NE
- National Insulation Office Remodel, Lincoln, NE
- Nebraska Rural Energy Association Office Expansion, Lincoln, NE
- Office of Disability Adjudication & Review, Jefferson City, MO
- Office of Disability Adjudication & Review, Springfield, MO
- Schrader and Sons Refuse Services Office Building, Lincoln, NE
- Social Security Administration Office Building, Burlington, IA
- Social Security Administration Office Building, Mason City, IA
- Social Security Administration Office Building, Ottumwa, IA
- Software Technologies Office Building, Lincoln, NE
- Voss Electric Corporate Office and Warehouse, Lincoln, NE
- Williamsburg Village, Multiple Office Buildings, Lincoln, NE



Brester Construction Corporate Office, Lincoln, NE

Recreation Projects



ADA

Copple Student Athlete Development Center

7400 A St, Lincoln, Nebraska

Seacrest Field, Lincoln Public Schools premier sports field complex, was in need of an update to its field facilities. ADA was tapped to design the modern and well-equipped field house to service football, soccer, band competitions and other events.

The new field house includes two areas to accommodate home and visiting teams. Each side consists of an expansive training room with adjacent showers and toilet facilities. In addition, a moderately sized field vehicle bay was included to allow access to both the football and baseball fields.



Ed & Mary Copple
Student Athlete
Development Center

Boosalis Park Indoor Shooting Range

14703 N 44th, Lincoln, Nebraska



Nebraska Game and Parks and the city of Lincoln approached ADA to design a new building at Boosalis Park. As part of the development plan for the park, this new building would act as a unique combination of shooting range and education center.

Boosalis Park has long been the home of the Lincoln area's archery and trap shooting clubs. The aging outdoor archery range and lack of modern plumbing were noted on the Parks Department concern list.

ADA developed a plan to combine the remote campus shooting range with other offsite offices within the new building. The metal shell houses employee offices, configurable meeting rooms, a 30-yard indoor archery range and a 25-yard indoor shooting range. The new building provides onsite teaching space for both theory and hands-on classes as well as monitored all weather conditions.



Recreation Experience

- Abbott Sports Complex, Lincoln, NE – Multiple Projects
- Ashland Country Club Addition, Ashland, NE
- Girl Scouts Lakeview Cabin, Lake Maloney, North Platte, NE
- Nebraska Tennis Center, Lincoln, NE
- Bison Sports Complex, Lincoln, NE
- Capital Indoor Sports Addition, Lincoln, NE
- Den Hartog Baseball Complex Storage Building, Lincoln, NE
- Lincoln Christian School Sports Complex & Tennis Courts Study, Lincoln, NE
- Pitch 2 Indoor Soccer Thunder Sports, Lincoln, NE
- Play It Again Sports, Lincoln, NE
- Rock Solid Gymnastics, Lincoln, NE
- Seacrest Field Concessions & Restrooms, Lincoln, NE
- Seacrest Field Sound & Lighting Project, Lincoln, NE
- Sherman Field Baseball Complex, Lincoln, NE
- Thunder Sports Complex Remodel, Lincoln, NE
- York Country Club Addition, York, NE



Hidden Valley Golf Course Club House, Lincoln, NE

Recreation Experience

- Abbott Sports Complex, Lincoln, NE – Multiple Projects
- Ashland Country Club Addition, Ashland, NE
- Girl Scouts Lakeview Cabin, Lake Maloney, North Platte, NE
- Nebraska Tennis Center, Lincoln, NE
- Bison Sports Complex, Lincoln, NE
- Capital Indoor Sports Addition, Lincoln, NE
- Den Hartog Baseball Complex Storage Building, Lincoln, NE
- Lincoln Christian School Sports Complex & Tennis Courts Study, Lincoln, NE
- Pitch 2 Indoor Soccer Thunder Sports, Lincoln, NE
- Play It Again Sports, Lincoln, NE
- Rock Solid Gymnastics, Lincoln, NE
- Seacrest Field Concessions & Restrooms, Lincoln, NE
- Seacrest Field Sound & Lighting Project, Lincoln, NE
- Sherman Field Baseball Complex, Lincoln, NE
- Thunder Sports Complex Remodel, Lincoln, NE
- York Country Club Addition, York, NE



Hidden Valley Golf Course Club House, Lincoln, NE

Religious Projects



ADA

Indian Hills Community Church

1000 S 84th St, Lincoln, Nebraska

ADA created the design for the renovation for the auditorium in the Indian Hills Community Church. This renovation began with the removal of 30 year old pews and carpeting.

The updated look included installing 1,496 new seats, installation of new floor and wall finishes, reconfiguring the stage / platform area, designing a new orchestra pit, and installing state of the art sound, lighting and media systems.



Good Shepherd Lutheran Church

3825 Wildbriar Ln, Lincoln, Nebraska



ADA's design for Good Shepherd Lutheran Church in south Lincoln included both an education and sanctuary addition to accommodate a growing congregation. The education addition features nine classrooms, church and school staff offices, expansion of the multipurpose room, support spaces, an elevator and kitchen. The sanctuary addition includes the main worship area, overflow space and balcony.

A generous commons area joins the sanctuary and multipurpose room through vaulted ceilings and skylights. While working with a limited budget, ADA was able to make a bold statement with beautiful heavy timber trusses. A sound consultant and an organ designer were brought in to ensure a well-integrated state-of-the-art sound system.



Religious Experience

- Christ's Place Church New Facility, Additions and Renovations, Lincoln, NE
- First Mennonite Church Addition, Lincoln, NE
- Good Shepherd Church Additions, Lincoln, NE
- Hope Community Church New Facility, Lincoln, NE
- St. Paul Lutheran Church Addition, Arlington, NE
- Indian Hills Community, Lincoln, NE
- Good Shepherd Lutheran Church Sanctuary and Education Additions
- Family of Christ Lutheran Church Preliminary Design for a new Building, Kearney, NE
- Temple Baptist Church Renovations, Lincoln, NE
- Crossroads Church Addition and Remodel, Lincoln, NE
- Heartland Baptist Church New Facility, Norfolk, NE
- Northwest Church of Christ Addition, Lincoln, NE
- Trinity Lutheran Church Kitchen Renovation, Lincoln, NE
- Trinity Lutheran Church Addition, Murdock, NE
- Cornerstone Bible Church Addition, Crete, NE
- Country Bible Church Master Plan, Bennet, NE
- First Presbyterian Church Roof, Lincoln, NE
- St. James Elevator Addition, Crete, NE
- St. Patrick's Church Elevator Addition, McCook, NE
- Calvary Baptist Church New Facility, Cortland, NE
- Old Cheney Alliance Church, Lincoln, NE
- Immanuel Lutheran Church Addition, Lincoln, NE
- Indian Hills Community Church, Lincoln, NE:
 - New Church Facility
 - Auditorium and South Entry Remodel
 - Stage Remodel
 - Kitchen Remodel
 - Education Addition
 - East Office Remodel
 - South Reception Desk Renovation
 - Second Floor Classrooms



Hope Church, Lincoln, NE

Religious Experience

- Christ's Place Church New Facility, Additions and Renovations, Lincoln, NE
- First Mennonite Church Addition, Lincoln, NE
- Good Shepherd Church Additions, Lincoln, NE
- Hope Community Church New Facility, Lincoln, NE
- St. Paul Lutheran Church Addition, Arlington, NE
- Indian Hills Community, Lincoln, NE
- Good Shepherd Lutheran Church Sanctuary and Education Additions
- Family of Christ Lutheran Church Preliminary Design for a new Building, Kearney, NE
- Temple Baptist Church Renovations, Lincoln, NE
- Crossroads Church Addition and Remodel, Lincoln, NE
- Heartland Baptist Church New Facility, Norfolk, NE
- Northwest Church of Christ Addition, Lincoln, NE
- Trinity Lutheran Church Kitchen Renovation, Lincoln, NE
- Trinity Lutheran Church Addition, Murdock, NE
- Cornerstone Bible Church Addition, Crete, NE
- Country Bible Church Master Plan, Bennet, NE
- First Presbyterian Church Roof, Lincoln, NE
- St. James Elevator Addition, Crete, NE
- St. Patrick's Church Elevator Addition, McCook, NE
- Calvary Baptist Church New Facility, Cortland, NE
- Old Cheney Alliance Church, Lincoln, NE
- Immanuel Lutheran Church Addition, Lincoln, NE
- Indian Hills Community Church, Lincoln, NE:
 - New Church Facility
 - Auditorium and South Entry Remodel
 - Stage Remodel
 - Kitchen Remodel
 - Education Addition
 - East Office Remodel
 - South Reception Desk Renovation
 - Second Floor Classrooms



Hope Church, Lincoln, NE

Residential Projects



ADA

Greenview Estates

1834 N 18th St, Omaha, Nebraska

Built under the Nebraska Green Building Program, Greenview Estates is comprised of 14 row houses and a series of duplexes.

The complex provides options of two, three and four-bedroom units as well as private drives, off street parking, community playground, and security fencing.



Multi-Family Housing

- Country Clover Estates, O'Neill, NE
- Williamsburg Park Apartments, Lincoln, NE
- Little Priest Apartments, Ho-Chunk Village, NE
- Bethesda Homes Renovation, Omaha, NE
- Alpha Omega House for Indian Hills Community Church, Lincoln, NE
- Embassy Park Apartments, Lincoln, NE
- Hoegemeyer-Palmer Apartments, Lincoln, NE
- Auburn Apartments, Auburn, NE
- Claremont Apartments, Lincoln, NE

- Somers Pointe, Fremont, NE
- South Rock Creek Estates, Shawnee, OK
- Stonebrook Villas, Konawa, OK
- The Oaks Retirement Community, Wayne, NE
- The Village at Heartland Park II, Seward, NE
- Terrace Heights Apartments, Auburn, NE
- West Park Townhomes, North Platte, NE
- Whispering Meadows, Wewoka, OK
- Wilderness Falls Senior Housing, Falls City, NE
- Willow Ridge Retirement Community, McCook, NE
- Eaglecrest Retirement Community, Salina, KS

Independent Living & Retirement Communities

- Liberty Estates Townhomes, Waverly, NE
- Marysville Senior Housing, Marysville, KS
- Rosewood Estates, Alliance, NE
- Woodland Park Townhomes, Grand Island, NE
- Yorktowne Estates, York, NE
- CHARMED-Perkins Phases I & II, Perkins, OK
- Cypress Pointe, Omaha, NE
- Eaglecrest Retirement Community, Salina, KS
- Great West Townhomes, Ogallala, NE
- Humboldt Senior Community, Humboldt, KS
- James Tinsley Villas, Omaha, NE
- Minden West Estates, Minden, NE
- Parkland Townhomes, Prague, OK
- Riverside Lodge, Grand Island, NE
- Savannah Pines Retirement Community, Lincoln, NE
- Shannon Heights, Omaha, NE



Scenic Pointe Apartments, Manhattan, KS

Restaurant Projects



ADA

Slim Chickens

84th & Old Cheney -- 16th & Pine Lake - Lincoln, Nebraska

ADA worked with the local owner of a new national Slim Chickens franchise on two new sites in southern Lincoln with possible future locations across Lincoln and even into the Omaha area.

The buildings were developed from a prototype layout but modified to fit constrained sites. Both locations were added to existing developments with standards for both clear distance between buildings and parking requirements.



Restaurant & Food Service Experience

- Westfield: Gateway Food Court Renovation, Lincoln, NE
- Slim Chickens, Lincoln, NE
- Erbert & Gerbert's - Java Zone, Lincoln, NE
- Applebee's Neighborhood Bar and Grill, Williamsburg Village, Lincoln, NE
- Dairy Queen Grille & Chill, Lincoln, NE
- Taco John's New Facility, 48th & Vine, Lincoln, NE
- Amigos/A&W – Highland Village, Lincoln, NE
- Ashland Country Club Dining Room Expansion, Ashland, NE
- Ay Chihuahua Restaurant/Bakery Remodel, Lincoln, NE
- Big Apple Bagels – 2 Locations, Lincoln, NE
- Billy Frogg's Restaurant, Lincoln, NE
- Blimpies Salads & Subs – 3 Locations, Lincoln, NE
- Blue Moon Coffee, Gateway Mall Food Court, Lincoln, NE
- Burger King Remodel, Lincoln, NE
- Canyon Coffee Shop, Lincoln, NE
- D'Leon's Mexican Restaurant, Lincoln, NE
- Dairy Queen Tenant Finish, Gateway Mall Food Court, Lincoln, NE
- Dairy Queen Tenant Finish, Ashland, NE
- Florios Tenant Finish, Lincoln, NE
- French Quarter Restaurant, Lincoln, NE
- Gloria Jean's Coffee House – 4 Locations, Lincoln, NE
- Green Gateau Reception Hall, Lincoln, NE
- Honest Abe's Meadowlane Remodel, Lincoln, NE
- Jabrisco's Renovation, Lincoln, NE
- Lazlo's Remodel, Lincoln, NE
- Panera Bread & Hu Hot Mongolian Grill Exterior Façade, Lincoln, NE
- Parker's Smokehouse, Lincoln, NE
- Pfizer Animal Health Cafeteria Remodel, Lincoln, NE
- Rocky Mountain Chocolate Tenant Finish, Gateway Mall Food Court, Lincoln, NE
- Salsarita, Lincoln, NE
- Sbarro's – UNL Nebraska Hall, Lincoln, NE
- Shar-E-Punjab Indian Restaurant, Lincoln, NE
- St. Elizabeth's Cafeteria Remodel, Lincoln, NE
- Subway Sandwich Shop – 3 Locations, Lincoln, NE
- Subway Tenant Finish, Gateway Mall Food Court, Lincoln, NE
- Taco Inn, Lincoln, NE
- Tandoor Indian Cuisine, Lincoln, NE
- Valentino's On-The-Go C-Store, Lincoln, NE
- York Country Club Addition, York, NE



Gateway Mall Food Court Renovation, Lincoln, NE

Retail Projects



ADA

Westfield; Gateway Mall, Food Court Renovation

6100 O St, Lincoln, Nebraska

The Westfield Group selected ADA to relocate the Gateway Mall food court and design additional updates to the northwest side of the mall.

The new food court is a popular destination for shoppers, providing an open and airy commons area for seating and circulation.

The mall was in full operation during the project, so construction was carefully phased for minimum impact on tenants and customers.



Victorian Ridge Retail Center

5901 S 85th St, Lincoln, Nebraska



The Victorian Ridge Retail Center was designed by ADA to fill-out the development at the intersection of So. 84th Street and Old Cheney Road.

The larger space was dedicated to the owner's Tae Kwon Do training center, with three similarly sized rentable bays occupying the remaining volume.



Retail Experience

- U-Stop/Whitehead Oil -- Multiple Projects
- Marshalls - Homegoods Storefront, Lincoln, NE
- Mobil On The Go/Valentino's To Go, Lincoln, NE
- Ollie's Convenience Store/McDonald's Restaurant, Waverly, NE
- Victorian Ridge Retail Center, Lincoln, NE
- Ben Franklin Addition, Lincoln, NE
- Canyon Coffee Company Tenant Finish, Lincoln, NE
- Carol Wright Sales, Lincoln, NE
- Coyote Willy's Expansion / Renovation, Lincoln, NE
- Dr. Leonard / Carol Wright Sales Office Expansion, Lincoln, NE
- Ellyne Bridal Tenant Finish, Lincoln, NE
- Friendly's Truck Stop Remodel, Nebraska City, NE
- H & H Self Storage, Multiple Buildings, Hickman, NE
- Jim's Home Health, Multiple Projects, Lincoln, NE
- LM Berry Tenant Finish, Lincoln, NE
- Lynnco Power Pick Building, Lincoln, NE
- Max Muscle Tenant Finish and Expansion, Lincoln, NE
- Midlands Packaging Warehouse Addition, Lincoln, NE
- Piedmont Fitness Center, Lincoln, NE
- Rocky Mountain Chocolate Factory Tenant Finish, Lincoln, NE
- Ryan Plumbing Tenant Finish, Lincoln, NE
- Secure Recyclers Tenant Finish, Lincoln, NE
- Solution One Building Remodel, Lincoln, NE
- South West Auto Remodel, Lincoln, NE
- Stem Gallery Remodel, Lincoln, NE
- Tamarin Ridge Retail Center, Lincoln, NE
- Three Eagles Communications Remodel, Lincoln, NE
- Universal Dance Academy Remodel, Lincoln, NE
- Western Cellular Lease Space, Lincoln, NE
- Wilderness Hills Retail Shop Infill, Lincoln, NE
- Williams Cleaners at Pioneer's Pointe Plaza, Lincoln, NE
- Westfield -- Multiple Projects



U-Stop & McDonald's, Lincoln, NE

- U-Stop/Whitehead Oil -- Multiple Projects
- Marshalls - Homegoods Storefront, Lincoln, NE
- Mobil On The Go/Valentino's To Go, Lincoln, NE
- Ollie's Convenience Store/McDonald's Restaurant, Waverly, NE
- Victorian Ridge Retail Center, Lincoln, NE
- Ben Franklin Addition, Lincoln, NE
- Canyon Coffee Company Tenant Finish, Lincoln, NE
- Carol Wright Sales, Lincoln, NE
- Coyote Willy's Expansion / Renovation, Lincoln, NE
- Dr. Leonard / Carol Wright Sales Office Expansion, Lincoln, NE
- Ellyne Bridal Tenant Finish, Lincoln, NE
- Friendly's Truck Stop Remodel, Nebraska City, NE
- H & H Self Storage, Multiple Buildings, Hickman, NE
- Jim's Home Health, Multiple Projects, Lincoln, NE
- LM Berry Tenant Finish, Lincoln, NE
- Lynnco Power Pick Building, Lincoln, NE
- Max Muscle Tenant Finish and Expansion, Lincoln, NE
- Midlands Packaging Warehouse Addition, Lincoln, NE
- Piedmont Fitness Center, Lincoln, NE
- Rocky Mountain Chocolate Factory Tenant Finish, Lincoln, NE
- Ryan Plumbing Tenant Finish, Lincoln, NE
- Secure Recyclers Tenant Finish, Lincoln, NE
- Solution One Building Remodel, Lincoln, NE
- South West Auto Remodel, Lincoln, NE
- Stem Gallery Remodel, Lincoln, NE
- Tamarin Ridge Retail Center, Lincoln, NE
- Three Eagles Communications Remodel, Lincoln, NE
- Universal Dance Academy Remodel, Lincoln, NE
- Western Cellular Lease Space, Lincoln, NE
- Wilderness Hills Retail Shop Infill, Lincoln, NE
- Williams Cleaners at Pioneer's Pointe Plaza, Lincoln, NE
- Westfield -- Multiple Projects



U-Stop & McDonald's, Lincoln, NE

Architectural Design Associates
3410 O Street, Suite A
Lincoln, NE 68520
402.486.3232

ADA